

PLACER  
NATURE CENTER

- A. Exhibit Hall
- B. Library
- C. Office

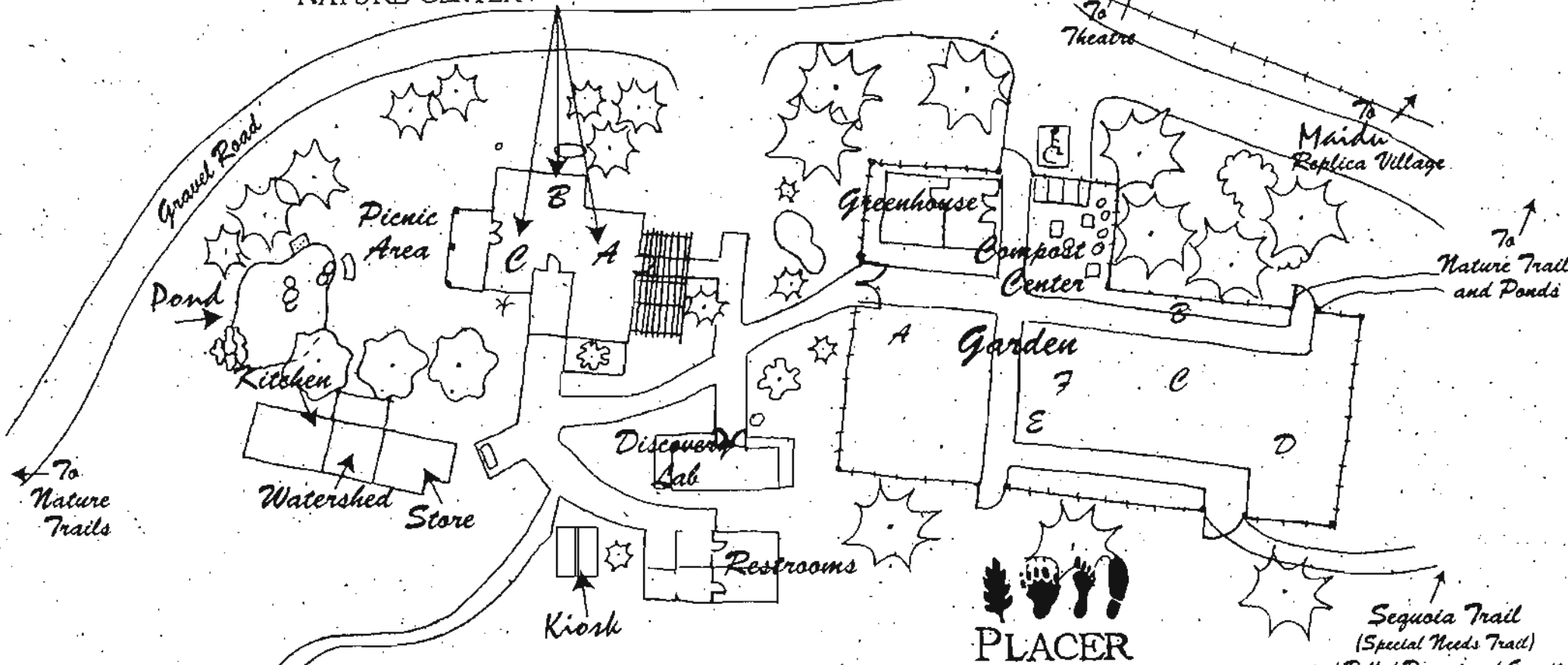

PLACER  
NATURE CENTER  
Garden Key

- A. Girl Scouts' Hummingbird and Butterfly Garden
- B. Iris
- C. Placer County History Garden
- D. Placer County History Orchard
- E. Enabling Garden
- F. Backyard Orchard Culture



(530) 878-6053

[www.PlacerNatureCenter.org](http://www.PlacerNatureCenter.org)  
[info@PlacerNatureCenter.org](mailto:info@PlacerNatureCenter.org)